

# OONO<sup>®</sup>

## CZH-LABS.com

### Screw Terminal Block Breakout Board for ESP8266-DevKitC

Model: D-1357

(SUK MD-D1357-1 / MD-D1357T-1)

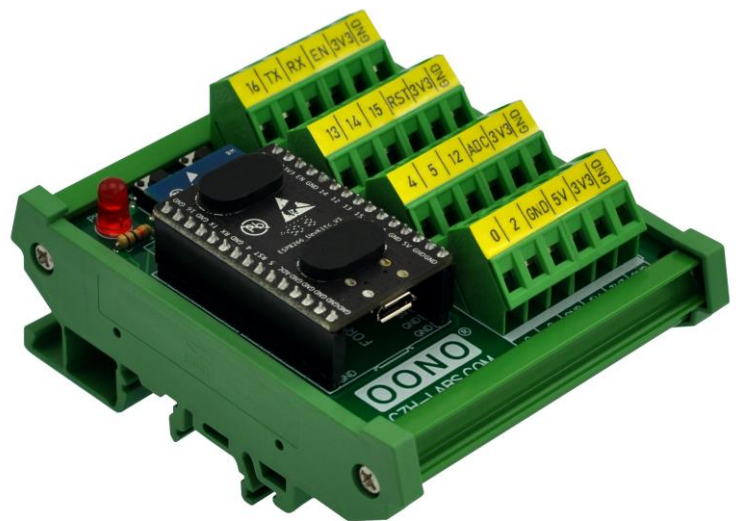
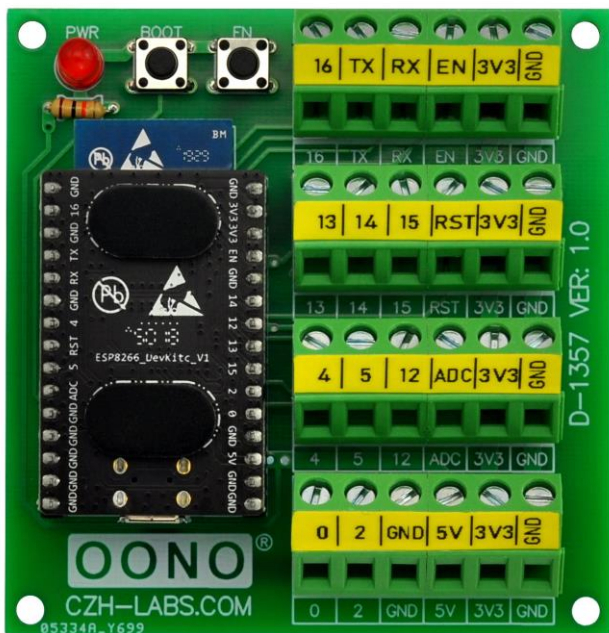

**Note:**

The breakout board supports ESPRESSIF official ESP8266-DevKitC, but we do not guarantee whether to support third-party modules, you can check the ESPRESSIF official website for more information before buying.

**ESPRESSIF official website:**

[https://www.espressif.com/sites/default/files/documentation/ESP8266-DevKitC\\_getting\\_started\\_guide\\_EN.pdf](https://www.espressif.com/sites/default/files/documentation/ESP8266-DevKitC_getting_started_guide_EN.pdf)

**Schematic:**

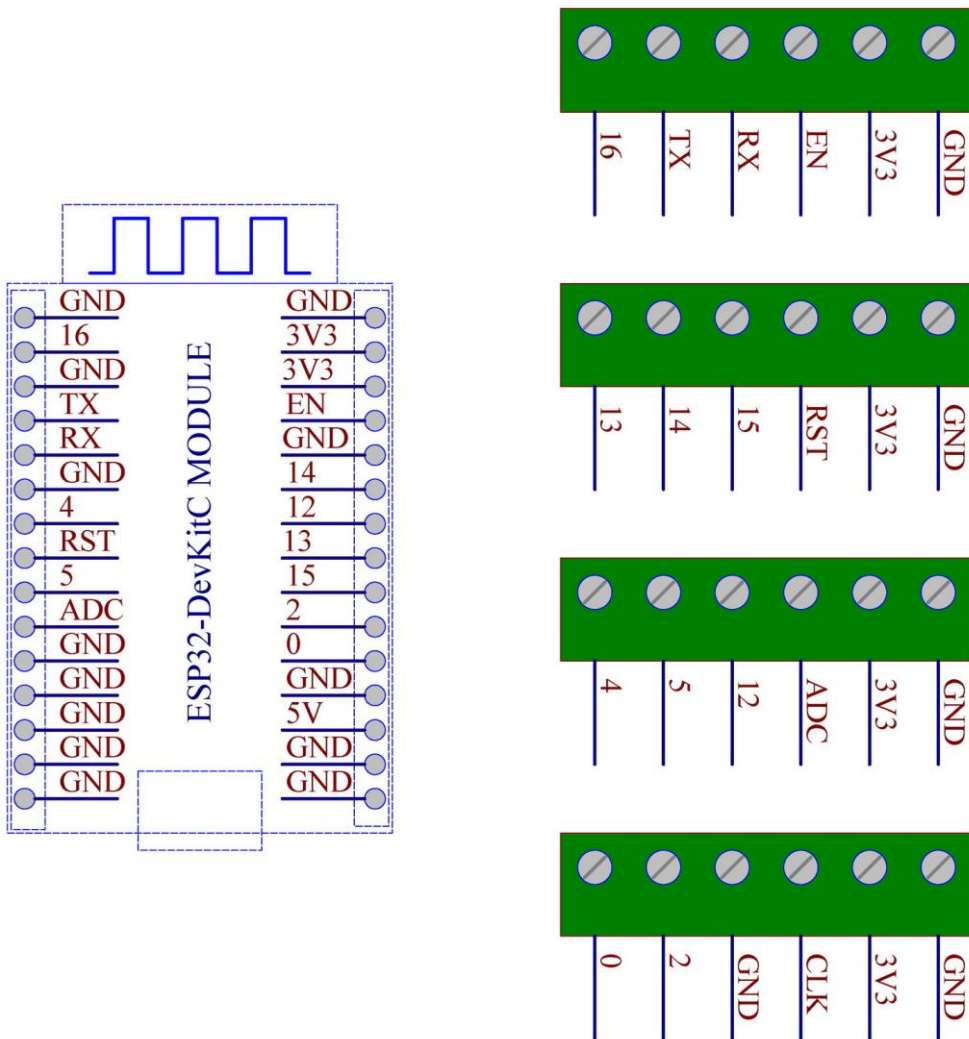

# Dimensions:

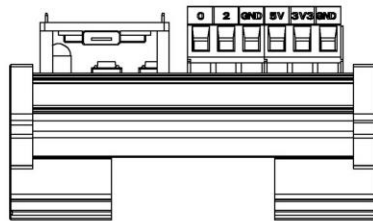
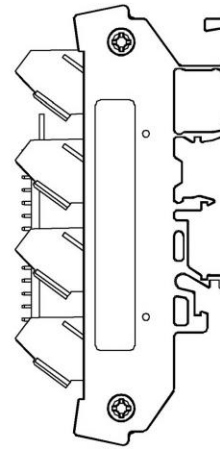
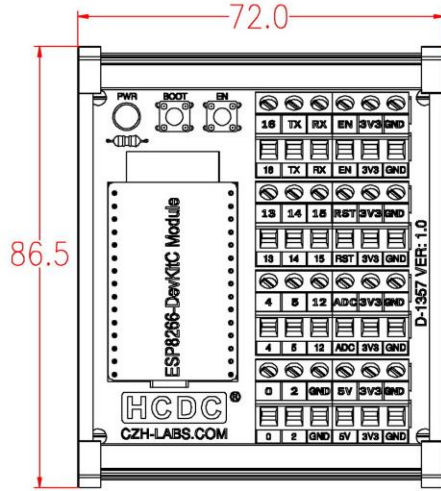
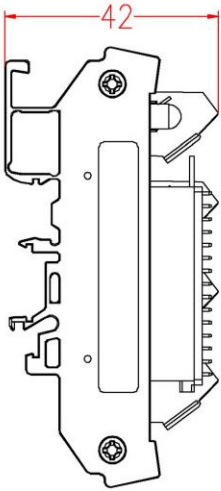
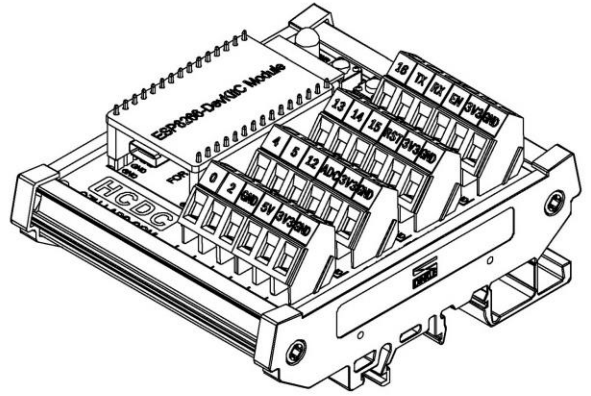
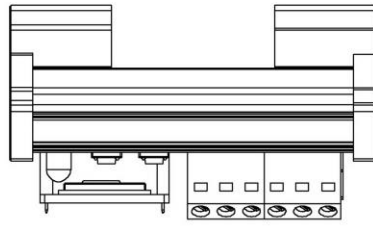

size unit:mm

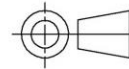

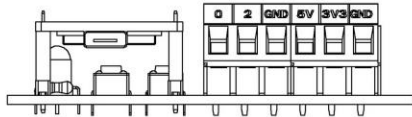
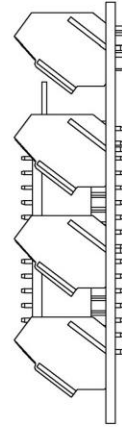
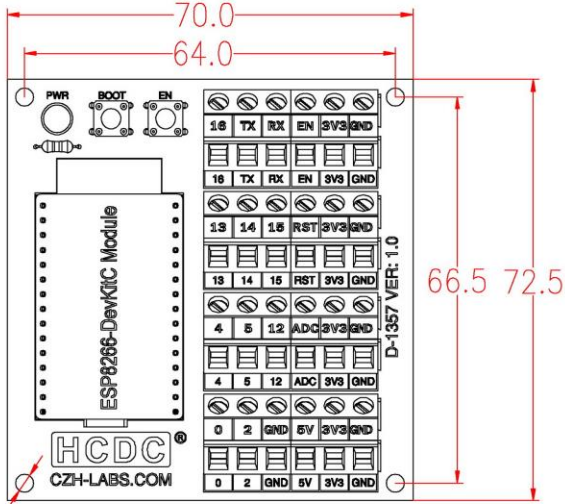
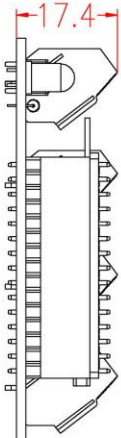
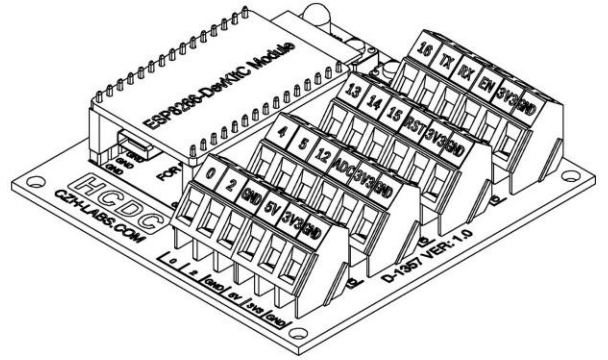
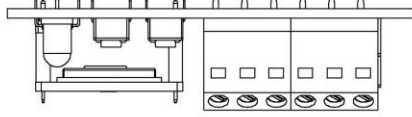

size unit:mm

